

Light-Weight Class Floor P&F Conveyor

FJ2-L5



POINTS

- Possible to stable transportation, because there is little rolling
- For the power chain is L5, ability for system becomes
- Minimum turning radius of horizontal corner is 400mm.



Main Specification

■ Work weight	Max.70kg (including carrier weight) (standard 30kg at up/down)
■ Transfer speed	Max.18m/min.
■ Vertical rail	Min.2000mm turning radius
■ Horizontal rail	Min.400mm turning radius
■ Storage pitch	Single type 325 to 440mm Double type 450 to 940mm Triple type 950 to (1350)mm
■ Transfer pitch	Upper than 600mm
■ Max. slope angle	30° (by work weight limit)
■ Stopper	■ Lubricator device
■ Turn device	■ Index device
■ Divergence & Junction device	■ Drop & Lift device

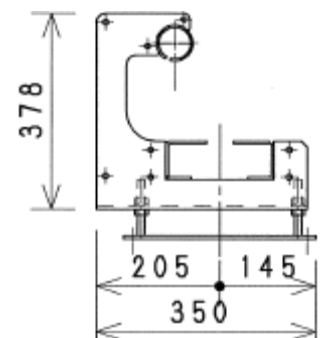

PAT商品